

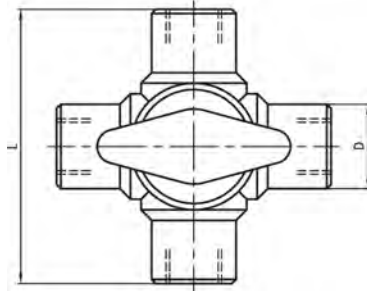

- 1) Thread seam-less in accordance with DIN, USAS or JIS ⇒ Numerous connection options
- 2) Nominal diameter DN 03 to DN 10 high KV value ⇒ Good flow rate even with soiled media
- 3) Sealing sleeve made of PTFE ⇒ Max. media resistance
- 4) Stem sealing with O-ring
- 5) Ball and stem made in one piece ⇒ Maximum tightness
- 6) Simultaneous centring and sealing of the ball ⇒ Maximum tightness also at the connections

The Series 6L ball valves are light and compact. They are available in various nominal diameters and versions with female G- or NPTthreads – from the simple 2-way valve to the versatile 5-way valve. The materials available (PP, PP natural, PVDF and PFA) provide high media resistance and thus offer a wide range of applications. A special fastening system makes assembly straightforward wherever required.

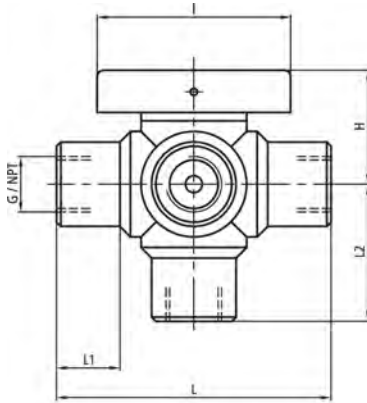

Article-Nr	Nominal Diameter	Connection	Material
6L701F0318PPFP	DN03	G1/8"	PP/FPM
6L701F0318PVFP	DN03	G1/8"	PVDF/FPM
6L701F0414PFEP	DN04	G1/4"	PFA/EPDM
6L701F0414PFFK	DN04	G1/4"	PFA/FFKM
6L701F0414PFFP	DN04	G1/4"	PFA/FPM
6L701F0414PNEP	DN04	G1/4"	PP-NATUR/EPDM
6L701F0414PNFP	DN04	G1/4"	PP-NATUR/FPM
6L701F0414PPEP	DN04	G1/4"	PP/EPDM
6L701F0414PPFP	DN04	G1/4"	PP/FPM
6L701F0414PVEP	DN04	G1/4"	PVDF/EPDM
6L701F0414PVFK	DN04	G1/4"	PVDF/FFKM
6L701F0414PVFP	DN04	G1/4"	PVDF/FPM
6L701F0614PFFK	DN06	G1/4"	PFA/FFKM
6L701F0614PFFP	DN06	G1/4"	PFA/FPM
6L701F0614PNFP	DN06	G1/4"	PP-NATUR/FPM
6L701F0614PPEP	DN06	G1/4"	PP/EPDM
6L701F0614PPFK	DN06	G1/4"	PP/FFKM
6L701F0614PPFP	DN06	G1/4"	PP/FPM
6L701F0614PVEP	DN06	G1/4"	PVDF/EPDM
6L701F0614PVFK	DN06	G1/4"	PVDF/FFKM
6L701F0614PVFP	DN06	G1/4"	PVDF/FPM
6L701F0812PNFP	DN08	G1/2"	PP-NATUR/FPM
6L701F0812PPFP	DN08	G1/2"	PP/FPM
6L701F0812PVFP	DN08	G1/2"	PVDF/FPM
6L701F1012PFEP	DN10	G1/2"	PFA/EPDM
6L701F1012PFFK	DN10	G1/2"	PFA/FFKM
6L701F1012PFFP	DN10	G1/2"	PFA/FPM
6L701F1012PNEP	DN10	G1/2"	PP-NATUR/EPDM
6L701F1012PNFP	DN10	G1/2"	PP-NATUR/FPM
6L701F1012PPEP	DN10	G1/2"	PP/EPDM
6L701F1012PPFP	DN10	G1/2"	PP/FPM
6L701F1012PVEP	DN10	G1/2"	PVDF/EPDM
6L701F1012PVFK	DN10	G1/2"	PVDF/FFKM
6L701F1012PVFP	DN10	G1/2"	PVDF/FPM
6L801F0318PFFP	DN03	NPT1/8"	PFA/FPM
6L801F0318PPFP	DN03	NPT1/8"	PP/FPM
6L801F0318PVFP	DN03	NPT1/8"	PVDF/FPM
6L801F0414PFEP	DN04	NPT1/4"	PFA/EPDM
6L801F0414PFFK	DN04	NPT1/4"	PFA/FFKM
6L801F0414PFFP	DN04	NPT1/4"	PFA/FPM
6L801F0414PNFP	DN04	NPT1/4"	PP-NATUR/FPM
6L801F0414PPEP	DN04	NPT1/4"	PP/EPDM
6L801F0414PPFP	DN04	NPT1/4"	PP/FPM
6L801F0414PVFK	DN04	NPT1/4"	PVDF/FFKM
6L801F0414PVFP	DN04	NPT1/4"	PVDF/FPM
6L801F0812PFEP	DN08	NPT1/2"	PFA/EPDM
6L801F0812PFFK	DN08	NPT1/2"	PFA/FFKM
6L801F0812PFFP	DN08	NPT1/2"	PFA/FPM
6L801F0812PPFP	DN08	NPT1/2"	PP/FPM
6L801F0812PVFK	DN08	NPT1/2"	PVDF/FFKM
6L801F0812PVFP	DN08	NPT1/2"	PVDF/FPM

Dimensions 6L...

	G / NPT	D	L	L1	L2	I	H
6L...	1/8"	16	52	13	26	39	~ 26
6L...	1/4"	20	65	15	32.5	40	~ 27
6L...	1/2"	30	100	22	-	58	~ 47

Materials 6L..., 6D..., 6H..., 6G..., 6R...

Housing	PP	PVDF	PFA
Ball	PP	PVDF	PTFE
Sealing sleeve	PTFE	PTFE	PTFE
Pressure screw**	PP	PVDF	PTFE
O-ring*	FPM	FPM	FPM

Technical data 6L . . .

Max. media temperature*	PP	PVDF	PFA		
	90 °C	120 °C	180 °C		
Pressure stage	PN 10				
Kvs-value	DN 03	DN 04	DN 06	DN 08	DN 10
6L701 . . .	0.5 m ³ /h	0.61 m ³ /h	0.9 m ³ /h	./.	3.9 m ³ /h
6L702 . . .	0.4 m ³ /h	0.58 m ³ /h	0.85 m ³ /h	./.	./.
6L732 . . .	0.4 m ³ /h	0.58 m ³ /h	0.85 m ³ /h	./.	3.7 m ³ /h
6L733 . . .	0.4 m ³ /h	0.58 m ³ /h	0.85 m ³ /h	./.	3.7 m ³ /h
6L741 . . .	0.5 m ³ /h	0.61 m ³ /h	0.9 m ³ /h	./.	3.9 m ³ /h
6L744 . . .	0.25 m ³ /h	0.45 m ³ /h	0.65 m ³ /h	./.	./.
6L750 . . .	0.4 m ³ /h	0.58 m ³ /h	0.85 m ³ /h	./.	./.
6L801 . . .	0.5 m ³ /h	0.61 m ³ /h	./.	1.9 m ³ /h	./.
6L802 . . .	0.4 m ³ /h	0.58 m ³ /h	./.	./.	./.
6L832 . . .	0.4 m ³ /h	0.58 m ³ /h	./.	1.6 m ³ /h	./.
6L833 . . .	0.4 m ³ /h	0.58 m ³ /h	./.	1.6 m ³ /h	./.
6L841 . . .	0.5 m ³ /h	0.61 m ³ /h	./.	1.6 m ³ /h	./.
6L844 . . .	0.25 m ³ /h	0.45 m ³ /h	./.	./.	./.
6L850 . . .	0.4 m ³ /h	0.58 m ³ /h	./.	./.	./.

* Starting from the nominal pressure rating (at 20 °C), the permissible pressure reduces with increasing temperature!

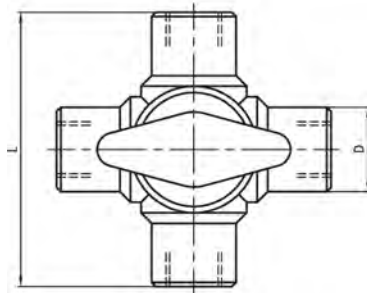
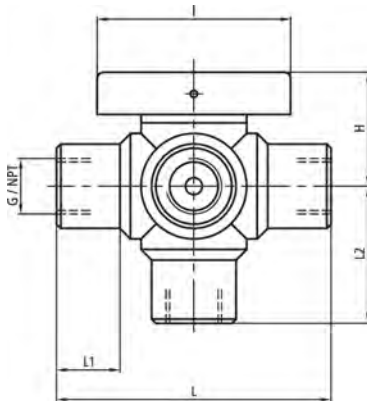

Article-Nr	Nominal Diameter	Connection	Material
6L702F0414PFFK	DN04	G1/4"	PFA/FFKM
6L702F0414PFFP	DN04	G1/4"	PFA/FPM
6L702F0414PPFP	DN04	G1/4"	PP/FPM
6L702F0414PVEP	DN04	G1/4"	PVDF/EPDM
6L702F0414PVFK	DN04	G1/4"	PVDF/FFKM
6L702F0414PVFP	DN04	G1/4"	PVDF/FPM
6L702F0614PFFP	DN06	G1/4"	PFA/FPM
6L702F0614PPFP	DN06	G1/4"	PP/FPM
6L702F0614PVFP	DN06	G1/4"	PVDF/FPM
6L802F0414PFFK	DN04	NPT1/4"	PFA/FFKM
6L802F0414PFFP	DN04	NPT1/4"	PFA/FPM
6L802F0414PPFP	DN04	NPT1/4"	PP/FPM
6L802F0414PVFP	DN04	NPT1/4"	PVDF/FPM

Dimensions 6L...

	G / NPT	D	L	L1	L2	I	H
6L...	1/8"	16	52	13	26	39	~ 26
6L...	1/4"	20	65	15	32.5	40	~ 27
6L...	1/2"	30	100	22	-	58	~ 47

Materials 6L..., 6D..., 6H..., 6G..., 6R...

Housing	PP	PVDF	PFA
Ball	PP	PVDF	PTFE
Sealing sleeve	PTFE	PTFE	PTFE
Pressure screw**	PP	PVDF	PTFE
O-ring*	FPM	FPM	FPM

Technical data 6L...

Max. media temperature*	PP	PVDF	PFA		
	90 °C	120 °C	180 °C		
Pressure stage	PN 10				
Kvs-value	DN 03	DN 04	DN 06	DN 08	DN 10
6L701...	0.5 m ³ /h	0.61 m ³ /h	0.9 m ³ /h	./.	3.9 m ³ /h
6L702...	0.4 m ³ /h	0.58 m ³ /h	0.85 m ³ /h	./.	./.
6L732...	0.4 m ³ /h	0.58 m ³ /h	0.85 m ³ /h	./.	3.7 m ³ /h
6L733...	0.4 m ³ /h	0.58 m ³ /h	0.85 m ³ /h	./.	3.7 m ³ /h
6L741...	0.5 m ³ /h	0.61 m ³ /h	0.9 m ³ /h	./.	3.9 m ³ /h
6L744...	0.25 m ³ /h	0.45 m ³ /h	0.65 m ³ /h	./.	./.
6L750...	0.4 m ³ /h	0.58 m ³ /h	0.85 m ³ /h	./.	./.
6L801...	0.5 m ³ /h	0.61 m ³ /h	./.	1.9 m ³ /h	./.
6L802...	0.4 m ³ /h	0.58 m ³ /h	./.	./.	./.
6L832...	0.4 m ³ /h	0.58 m ³ /h	./.	1.6 m ³ /h	./.
6L833...	0.4 m ³ /h	0.58 m ³ /h	./.	1.6 m ³ /h	./.
6L841...	0.5 m ³ /h	0.61 m ³ /h	./.	1.6 m ³ /h	./.
6L844...	0.25 m ³ /h	0.45 m ³ /h	./.	./.	./.
6L850...	0.4 m ³ /h	0.58 m ³ /h	./.	./.	./.

Ball valve (Series 6L), 3-way, horizontal, with L-bore

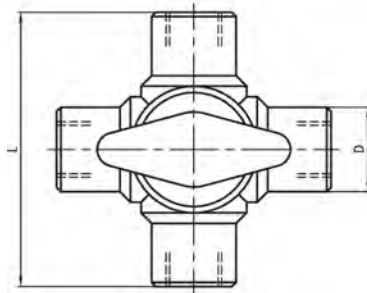
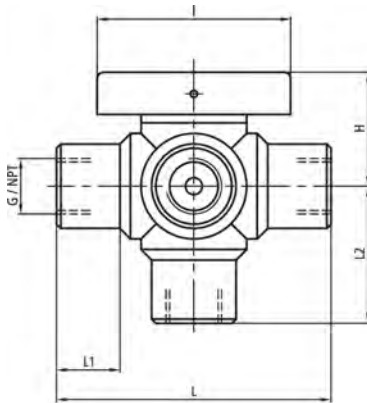

Article-Nr	Nominal Diameter	Connection	Material
6L732F0318PPEP	DN03	G1/8"	PP/EPDM
6L732F0318PPFP	DN03	G1/8"	PP/FPM
6L732F0318PVFP	DN03	G1/8"	PVDF/FPM
6L732F0414PFFK	DN04	G1/4"	PFA/FFKM
6L732F0414PPFP	DN04	G1/4"	PFA/FPM
6L732F0414PNFP	DN04	G1/4"	PP-NATUR/FPM
6L732F0414PPEP	DN04	G1/4"	PP/EPDM
6L732F0414PPFP	DN04	G1/4"	PP/FPM
6L732F0414PVEP	DN04	G1/4"	PVDF/EPDM
6L732F0414PVFK	DN04	G1/4"	PVDF/FFKM
6L732F0414PVFP	DN04	G1/4"	PVDF/FPM
6L732F0614PFFK	DN06	G1/4"	PFA/FFKM
6L732F0614PPFP	DN06	G1/4"	PFA/FPM
6L732F0614PNFP	DN06	G1/4"	PP-NATUR/FPM
6L732F0614PPEP	DN06	G1/4"	PP/EPDM
6L732F0614PPFP	DN06	G1/4"	PP/FPM
6L732F0614PVEP	DN06	G1/4"	PVDF/EPDM
6L732F0614PVFK	DN06	G1/4"	PVDF/FFKM
6L732F0614PVFP	DN06	G1/4"	PVDF/FPM
6L732F0812PPFP	DN08	G1/2"	PP/FPM
6L732F1012PFFK	DN10	G1/2"	PFA/FFKM
6L732F1012PPFP	DN10	G1/2"	PFA/FPM
6L732F1012PNFP	DN10	G1/2"	PP-NATUR/FPM
6L732F1012PPEP	DN10	G1/2"	PP/EPDM
6L732F1012PPFP	DN10	G1/2"	PP/FPM
6L732F1012PVFK	DN10	G1/2"	PVDF/FFKM
6L732F1012PVFP	DN10	G1/2"	PVDF/FPM
6L832F0318PPFP	DN03	NPT1/8"	PFA/FPM
6L832F0318PPFP	DN03	NPT1/8"	PP/FPM
6L832F0318PVFP	DN03	NPT1/8"	PVDF/FPM
6L832F0414PFFK	DN04	NPT1/4"	PFA/FFKM
6L832F0414PPFP	DN04	NPT1/4"	PFA/FPM
6L832F0414PNFP	DN04	NPT1/4"	PP-NATUR/FPM
6L832F0414PPFP	DN04	NPT1/4"	PP/FPM
6L832F0414PVFK	DN04	NPT1/4"	PVDF/FFKM
6L832F0414PVFP	DN04	NPT1/4"	PVDF/FPM
6L832F0812PPFP	DN08	NPT1/2"	PFA/FPM
6L832F0812PNFP	DN08	NPT1/2"	PP-NATUR/FPM
6L832F0812PPFP	DN08	NPT1/2"	PP/FPM
6L832F0812PVFK	DN08	NPT1/2"	PVDF/FFKM
6L832F0812PVFP	DN08	NPT1/2"	PVDF/FPM

Dimensions 6L...

	G / NPT	D	L	L1	L2	I	H
6L...	1/8"	16	52	13	26	39	~ 26
6L...	1/4"	20	65	15	32.5	40	~ 27
6L...	1/2"	30	100	22	-	58	~ 47

Materials 6L..., 6D..., 6H..., 6G..., 6R...

Housing	PP	PVDF	PFA
Ball	PP	PVDF	PTFE
Sealing sleeve	PTFE	PTFE	PTFE
Pressure screw**	PP	PVDF	PTFE
O-ring*	FPM	FPM	FPM

Technical data 6L...

Max. media temperature*	PP	PVDF	PFA
	90 °C	120 °C	180 °C

.....continued on the next page

Ball valve (Series 6L), 3-way, horizontal, with L-bore



Max. media temperature*	PP	PVDF	PFA		
Pressure stage	PN 10				
Kvs-value	DN 03	DN 04	DN 06	DN 08	DN 10
6L701...	0.5 m ³ /h	0.61 m ³ /h	0.9 m ³ /h	./.	3.9 m ³ /h
6L702...	0.4 m ³ /h	0.58 m ³ /h	0.85 m ³ /h	./.	./.
6L732...	0.4 m ³ /h	0.58 m ³ /h	0.85 m ³ /h	./.	3.7 m ³ /h
6L733...	0.4 m ³ /h	0.58 m ³ /h	0.85 m ³ /h	./.	3.7 m ³ /h
6L741...	0.5 m ³ /h	0.61 m ³ /h	0.9 m ³ /h	./.	3.9 m ³ /h
6L744...	0.25 m ³ /h	0.45 m ³ /h	0.65 m ³ /h	./.	./.
6L750...	0.4 m ³ /h	0.58 m ³ /h	0.85 m ³ /h	./.	./.
6L801...	0.5 m ³ /h	0.61 m ³ /h	./.	1.9 m ³ /h	./.
6L802...	0.4 m ³ /h	0.58 m ³ /h	./.	./.	./.
6L832...	0.4 m ³ /h	0.58 m ³ /h	./.	1.6 m ³ /h	./.
6L833...	0.4 m ³ /h	0.58 m ³ /h	./.	1.6 m ³ /h	./.
6L841...	0.5 m ³ /h	0.61 m ³ /h	./.	1.6 m ³ /h	./.
6L844...	0.25 m ³ /h	0.45 m ³ /h	./.	./.	./.
6L850...	0.4 m ³ /h	0.58 m ³ /h	./.	./.	./.

Ball valve (Series 6L), 3-way, horizontal, with T-bore

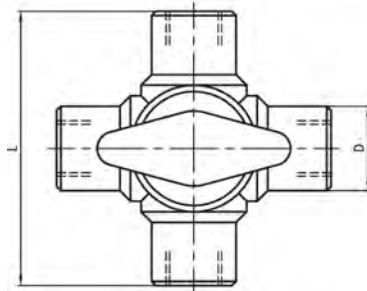
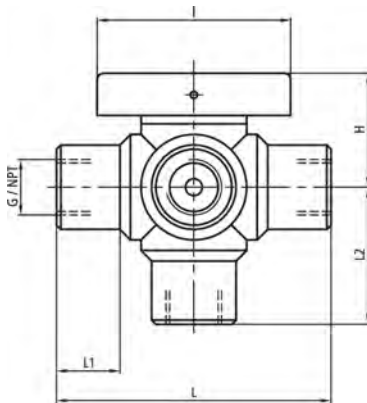

Article-Nr	Nominal Diameter	Connection	Material
6L733F0318PPFP	DN03	G1/8"	PP/FPM
6L733F0318PVFP	DN03	G1/8"	PVDF/FPM
6L733F0414PFFK	DN04	G1/4"	PFA/FFKM
6L733F0414PFFP	DN04	G1/4"	PFA/FPM
6L733F0414PNFP	DN04	G1/4"	PP-NATUR/FPM
6L733F0414PPEP	DN04	G1/4"	PP/EPDM
6L733F0414PPFP	DN04	G1/4"	PP/FPM
6L733F0414PVEP	DN04	G1/4"	PVDF/EPDM
6L733F0414PVFK	DN04	G1/4"	PVDF/FFKM
6L733F0414PVFP	DN04	G1/4"	PVDF/FPM
6L733F0614PFFK	DN06	G1/4"	PFA/FFKM
6L733F0614PFFP	DN06	G1/4"	PFA/FPM
6L733F0614PPELFP	DN06	G1/4"	PP-CONDUCTIVE/FPM
6L733F0614PPEP	DN06	G1/4"	PP/EPDM
6L733F0614PPFP	DN06	G1/4"	PP/FPM
6L733F0614PVEP	DN06	G1/4"	PVDF/EPDM
6L733F0614PVFP	DN06	G1/4"	PVDF/FPM
6L733F1012PFEP	DN10	G1/2"	PFA/EPDM
6L733F1012PFFK	DN10	G1/2"	PFA/FFKM
6L733F1012PFFP	DN10	G1/2"	PFA/FPM
6L733F1012PNFP	DN10	G1/2"	PP-NATUR/FPM
6L733F1012PPEP	DN10	G1/2"	PP/EPDM
6L733F1012PPFP	DN10	G1/2"	PP/FPM
6L733F1012PVEP	DN10	G1/2"	PVDF/EPDM
6L733F1012PVFK	DN10	G1/2"	PVDF/FFKM
6L733F1012PVFP	DN10	G1/2"	PVDF/FPM
6L833F0414PFFK	DN04	NPT1/4"	PFA/FFKM
6L833F0414PFFP	DN04	NPT1/4"	PFA/FPM
6L833F0414PVFK	DN04	NPT1/4"	PVDF/FFKM
6L833F0414PVFP	DN04	NPT1/4"	PVDF/FPM
6L833F0812PFEP	DN08	NPT1/2"	PFA/EPDM
6L833F0812PFFP	DN08	NPT1/2"	PFA/FPM
6L833F0812PVEP	DN08	NPT1/2"	PVDF/EPDM
6L833F0812PVFP	DN08	NPT1/2"	PVDF/FPM

Dimensions 6L...

	G / NPT	D	L	L1	L2	I	H
6L...	1/8"	16	52	13	26	39	~ 26
6L...	1/4"	20	65	15	32.5	40	~ 27
6L...	1/2"	30	100	22	-	58	~ 47

Materials 6L..., 6D..., 6H..., 6G..., 6R...

Housing	PP	PVDF	PFA
Ball	PP	PVDF	PTFE
Sealing sleeve	PTFE	PTFE	PTFE
Pressure screw**	PP	PVDF	PTFE
O-ring*	FPM	FPM	FPM

Technical data 6L...

Max. media temperature*	PP	PVDF	PFA		
	90 °C	120 °C	180 °C		
Pressure stage	PN 10				
Kvs-value	DN 03	DN 04	DN 06	DN 08	DN 10
6L701...	0.5 m ³ /h	0.61 m ³ /h	0.9 m ³ /h	./.	3.9 m ³ /h
6L702...	0.4 m ³ /h	0.58 m ³ /h	0.85 m ³ /h	./.	./.
6L732...	0.4 m ³ /h	0.58 m ³ /h	0.85 m ³ /h	./.	3.7 m ³ /h

.....continued on the next page

Ball valve (Series 6L), 3-way, horizontal, with T-bore



Max. media temperature*	PP	PVDF	PFA		
6L733...	0.4 m ³ /h	0.58 m ³ /h	0.85 m ³ /h	./.	3.7 m ³ /h
6L741...	0.5 m ³ /h	0.61 m ³ /h	0.9 m ³ /h	./.	3.9 m ³ /h
6L744...	0.25 m ³ /h	0.45 m ³ /h	0.65 m ³ /h	./.	./.
6L750...	0.4 m ³ /h	0.58 m ³ /h	0.85 m ³ /h	./.	./.
6L801...	0.5 m ³ /h	0.61 m ³ /h	./.	1.9 m ³ /h	./.
6L802...	0.4 m ³ /h	0.58 m ³ /h	./.	./.	./.
6L832...	0.4 m ³ /h	0.58 m ³ /h	./.	1.6 m ³ /h	./.
6L833...	0.4 m ³ /h	0.58 m ³ /h	./.	1.6 m ³ /h	./.
6L841...	0.5 m ³ /h	0.61 m ³ /h	./.	1.6 m ³ /h	./.
6L844...	0.25 m ³ /h	0.45 m ³ /h	./.	./.	./.
6L850...	0.4 m ³ /h	0.58 m ³ /h	./.	./.	./.

Ball valve (Series 6L), 4-way, with through bore

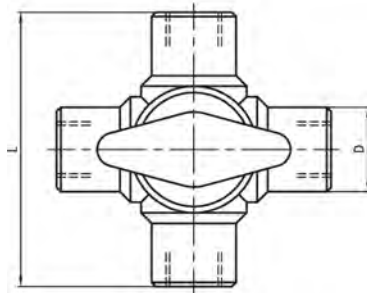
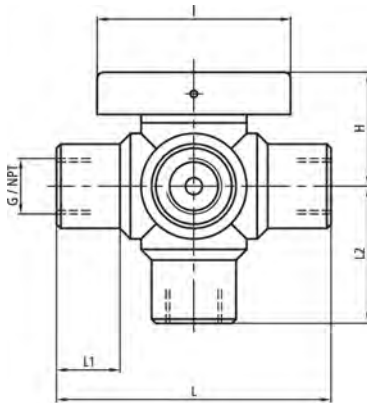

Article-Nr	Nominal Diameter	Connection	Material
6L741F0414PFFP	DN04	G1/4"	PFA/FPM
6L741F0414PPFP	DN04	G1/4"	PP/FPM
6L741F0414PVFP	DN04	G1/4"	PVDF/FPM

Dimensions 6L...

	G / NPT	D	L	L1	L2	I	H
6L...	1/8"	16	52	13	26	39	~ 26
6L...	1/4"	20	65	15	32.5	40	~ 27
6L...	1/2"	30	100	22	-	58	~ 47

Materials 6L..., 6D..., 6H..., 6G..., 6R...

Housing	PP	PVDF	PFA
Ball	PP	PVDF	PTFE
Sealing sleeve	PTFE	PTFE	PTFE
Pressure screw**	PP	PVDF	PTFE
O-ring*	FPM	FPM	FPM

Technical data 6L...

Max. media temperature*	PP	PVDF	PFA		
	90 °C	120 °C	180 °C		
Pressure stage	PN 10				
Kvs-value	DN 03	DN 04	DN 06	DN 08	DN 10
6L701...	0.5 m ³ /h	0.61 m ³ /h	0.9 m ³ /h	./.	3.9 m ³ /h
6L702...	0.4 m ³ /h	0.58 m ³ /h	0.85 m ³ /h	./.	./.
6L732...	0.4 m ³ /h	0.58 m ³ /h	0.85 m ³ /h	./.	3.7 m ³ /h
6L733...	0.4 m ³ /h	0.58 m ³ /h	0.85 m ³ /h	./.	3.7 m ³ /h
6L741...	0.5 m ³ /h	0.61 m ³ /h	0.9 m ³ /h	./.	3.9 m ³ /h
6L744...	0.25 m ³ /h	0.45 m ³ /h	0.65 m ³ /h	./.	./.
6L750...	0.4 m ³ /h	0.58 m ³ /h	0.85 m ³ /h	./.	./.
6L801...	0.5 m ³ /h	0.61 m ³ /h	./.	1.9 m ³ /h	./.
6L802...	0.4 m ³ /h	0.58 m ³ /h	./.	./.	./.
6L832...	0.4 m ³ /h	0.58 m ³ /h	./.	1.6 m ³ /h	./.
6L833...	0.4 m ³ /h	0.58 m ³ /h	./.	1.6 m ³ /h	./.
6L841...	0.5 m ³ /h	0.61 m ³ /h	./.	1.6 m ³ /h	./.
6L844...	0.25 m ³ /h	0.45 m ³ /h	./.	./.	./.
6L850...	0.4 m ³ /h	0.58 m ³ /h	./.	./.	./.

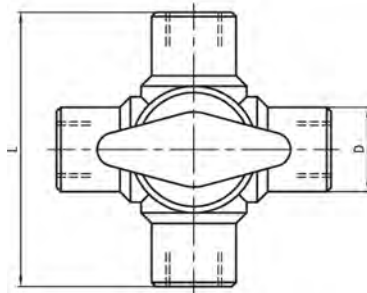
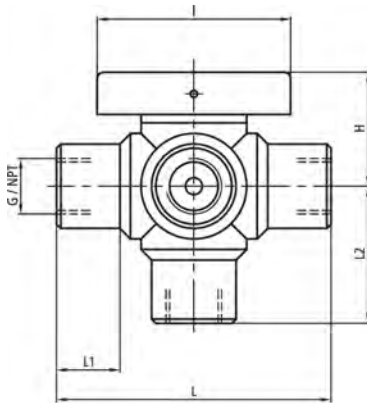

Article-Nr	Nominal Diameter	Connection	Material
6L744F0318PVFP	DN03	G1/8"	PVDF/FPM
6L744F0414PFFK	DN04	G1/4"	PFA/FFKM
6L744F0414PFFP	DN04	G1/4"	PFA/FPM
6L744F0414PPEP	DN04	G1/4"	PP/EPDM
6L744F0414PPFP	DN04	G1/4"	PP/FPM
6L744F0414PVEP	DN04	G1/4"	PVDF/EPDM
6L744F0414PVFK	DN04	G1/4"	PVDF/FFKM
6L744F0414PVFP	DN04	G1/4"	PVDF/FPM
6L744F0612PFFP	DN06	G1/2"	PFA/FPM
6L744F0612PPEP	DN06	G1/2"	PP/EPDM
6L744F0612PPFP	DN06	G1/2"	PP/FPM
6L744F0612PVFP	DN06	G1/2"	PVDF/FPM
6L844F0414PPFP	DN04	NPT1/4"	PP/FPM
6L844F0414PVFP	DN04	NPT1/4"	PVDF/FPM

Dimensions 6L...

	G / NPT	D	L	L1	L2	I	H
6L...	1/8"	16	52	13	26	39	~ 26
6L...	1/4"	20	65	15	32.5	40	~ 27
6L...	1/2"	30	100	22	-	58	~ 47

Materials 6L..., 6D..., 6H..., 6G..., 6R...

Housing	PP	PVDF	PFA
Ball	PP	PVDF	PTFE
Sealing sleeve	PTFE	PTFE	PTFE
Pressure screw**	PP	PVDF	PTFE
O-ring*	FPM	FPM	FPM

Technical data 6L...

Max. media temperature*	PP	PVDF	PFA		
	90 °C	120 °C	180 °C		
Pressure stage	PN 10				
Kvs-value	DN 03	DN 04	DN 06	DN 08	DN 10
6L701...	0.5 m ³ /h	0.61 m ³ /h	0.9 m ³ /h	./.	3.9 m ³ /h
6L702...	0.4 m ³ /h	0.58 m ³ /h	0.85 m ³ /h	./.	./.
6L732...	0.4 m ³ /h	0.58 m ³ /h	0.85 m ³ /h	./.	3.7 m ³ /h
6L733...	0.4 m ³ /h	0.58 m ³ /h	0.85 m ³ /h	./.	3.7 m ³ /h
6L741...	0.5 m ³ /h	0.61 m ³ /h	0.9 m ³ /h	./.	3.9 m ³ /h
6L744...	0.25 m ³ /h	0.45 m ³ /h	0.65 m ³ /h	./.	./.
6L750...	0.4 m ³ /h	0.58 m ³ /h	0.85 m ³ /h	./.	./.
6L801...	0.5 m ³ /h	0.61 m ³ /h	./.	1.9 m ³ /h	./.
6L802...	0.4 m ³ /h	0.58 m ³ /h	./.	./.	./.
6L832...	0.4 m ³ /h	0.58 m ³ /h	./.	1.6 m ³ /h	./.
6L833...	0.4 m ³ /h	0.58 m ³ /h	./.	1.6 m ³ /h	./.
6L841...	0.5 m ³ /h	0.61 m ³ /h	./.	1.6 m ³ /h	./.
6L844...	0.25 m ³ /h	0.45 m ³ /h	./.	./.	./.
6L850...	0.4 m ³ /h	0.58 m ³ /h	./.	./.	./.

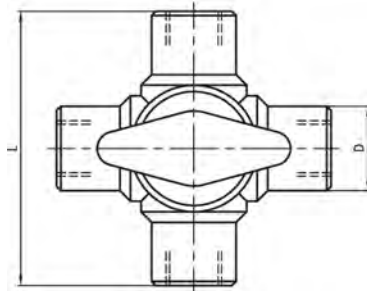
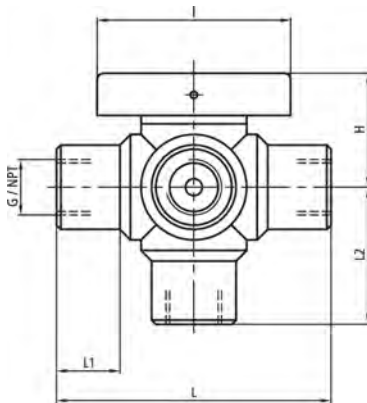

Article-Nr	Nominal Diameter	Connection	Material
6L750F0318PPFP	DN03	G1/8"	PP/FPM
6L750F0318PVFP	DN03	G1/8"	PVDF/FPM
6L750F0414PFFK	DN04	G1/4"	PFA/FFKM
6L750F0414PFFP	DN04	G1/4"	PFA/FPM
6L750F0414PPFP	DN04	G1/4"	PP/FPM
6L750F0414PVFK	DN04	G1/4"	PVDF/FFKM
6L750F0414PVFP	DN04	G1/4"	PVDF/FPM
6L850F0414PFFP	DN04	NPT1/4"	PFA/FPM
6L850F0414PPFP	DN04	NPT1/4"	PP/FPM
6L850F0414PVFP	DN04	NPT1/4"	PVDF/FPM

Dimensions 6L...

	G / NPT	D	L	L1	L2	I	H
6L...	1/8"	16	52	13	26	39	~ 26
6L...	1/4"	20	65	15	32.5	40	~ 27
6L...	1/2"	30	100	22	-	58	~ 47

Materials 6L..., 6D..., 6H..., 6G..., 6R...

Housing	PP	PVDF	PFA
Ball	PP	PVDF	PTFE
Sealing sleeve	PTFE	PTFE	PTFE
Pressure screw**	PP	PVDF	PTFE
O-ring*	FPM	FPM	FPM

Technical data 6L...

Max. media temperature*	PP	PVDF	PFA		
	90 °C	120 °C	180 °C		
Pressure stage	PN 10				
Kvs-value	DN 03	DN 04	DN 06	DN 08	DN 10
6L701...	0.5 m ³ /h	0.61 m ³ /h	0.9 m ³ /h	./.	3.9 m ³ /h
6L702...	0.4 m ³ /h	0.58 m ³ /h	0.85 m ³ /h	./.	./.
6L732...	0.4 m ³ /h	0.58 m ³ /h	0.85 m ³ /h	./.	3.7 m ³ /h
6L733...	0.4 m ³ /h	0.58 m ³ /h	0.85 m ³ /h	./.	3.7 m ³ /h
6L741...	0.5 m ³ /h	0.61 m ³ /h	0.9 m ³ /h	./.	3.9 m ³ /h
6L744...	0.25 m ³ /h	0.45 m ³ /h	0.65 m ³ /h	./.	./.
6L750...	0.4 m ³ /h	0.58 m ³ /h	0.85 m ³ /h	./.	./.
6L801...	0.5 m ³ /h	0.61 m ³ /h	./.	1.9 m ³ /h	./.
6L802...	0.4 m ³ /h	0.58 m ³ /h	./.	./.	./.
6L832...	0.4 m ³ /h	0.58 m ³ /h	./.	1.6 m ³ /h	./.
6L833...	0.4 m ³ /h	0.58 m ³ /h	./.	1.6 m ³ /h	./.
6L841...	0.5 m ³ /h	0.61 m ³ /h	./.	1.6 m ³ /h	./.
6L844...	0.25 m ³ /h	0.45 m ³ /h	./.	./.	./.
6L850...	0.4 m ³ /h	0.58 m ³ /h	./.	./.	./.