



Series PA Pneumatic Actuator

Asahi America, Inc. is now offering its Series 79PA- pneumatic actuator for quarter-turn valves. Actuator sizes range from A79PA through D579PA and are available in single action or double action.

This is a completely re-designed and re-engineered product that evolved from the Series 79P.

The Series 79PA actuator family feature extruded aluminum alloy body and end caps with a 2-part coating (Cataphoresis and Rilsan) inside and outside, bolted end caps, captive springs, dual bolt patterns for valve mounting, end position travel adjustments, and NAMUR solenoid mounting pad which has been rotated 90 degrees.

The Series PA actuator family also maintains NAMUR mounting for accessories and ISO5211 for valve mounting.

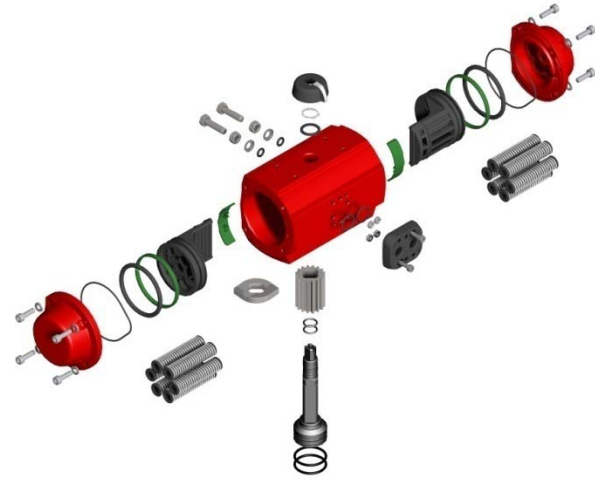

- We will begin to ship the new Series 79PA pneumatic actuators as the inventory of the Series 79P becomes depleted.
- The pricing for the new Series 79PA will remain the same as the Series 79P. For example, the B79PASN single acting actuator is the same price as the B79PSN single acting actuator.
- The Series 79PA has some physical differences, especially with the ISO 5211 output.

Please see actuator output chart below...

- The output torques have also changes somewhat.

Please see torque charts on next page...

MODEL	P-SERIES BCD	PA-SERIES BCD	P-SERIES OUTPUT SHAFT	PA-SERIES OUTPUT SHAFT
A79P	F04	F03/F04	0.433	0.433
B79P	F05	F04/F05	0.79	0.551
B579P	F05/F07	F05/F07	0.95	0.669
C79P	F05/F07	F05/F07	0.95	0.669
C579P	F05/F07	F05/F07	0.95	0.669
D79P	F05/F07	F05/F07	0.95	0.669
D579P*	F07/F10	F07/F10	1.18*	1.063*

***The E79PN & E79PSN output drive has also changed from a 1.18 star to a 1.063 star.**

Double Acting Output Torques

Model	Supply Pressure (psi)				
	40	60	80	100	120
A79P	64	103	138	173	210
B79P	94	147	201	257	310
B579P	191	296	402	509	614
C79P	268	418	576	730	882
C579P	450	692	942	1,194	1,441
D79P	633	980	1,339	1,699	2,051
D579P	1,140	1,741	2,351	2,964	3,606

Single Acting Output Torques

Model	Spring Set	40 psi		60 psi		80 psi		100 psi		120 psi		Spring Torque	
		Start	End	Start	End	Start	End	Start	End	Start	End	Start	End
A79PAS	2	45	32	81	66	116	102					35	21
	3	35	19	70	53	106	89	141	125			48	31
	4	27	7	61	39	97	75	133	112	168	146	62	40
	5					86	62	122	99	157	132	75	51
	6*					78	49	114	85	148	118	88	59
B79PAS	2	65	47	114	94	169	150					51	32
	3	47	25	94	70	150	126	207	183			75	51
	4			78	46	134	103	191	160	241	209	98	67
	5			61	21	118	79	175	137	224	184	122	83
	6*					103	55	160	113	209	159	146	98
B579PAS	2	128	92	224	184	333	294					108	69
	3	99	42	192	128	302	240	411	350			162	100
	4	78	14	169	96	279	209	388	319	487	415	193	123
	5			136	49	248	162	358	274	455	367	239	154
	6*					217	123	327	235	423	327	278	185
C79PAS	2	184	144	323	278	485	442					134	91
	3	142	82	277	209	440	374	596	531			202	136
	4	101	20	230	139	395	307	551	465	695	604	269	181
	5			182	70	349	240	506	399	647	535	336	227
	6*					303	172	461	332	601	465	403	272
C579PAS	2	317	256	543	474	798	731					210	144
	3	250	159	468	365	725	626	980	882			316	217
	4	183	61	393	255	652	519	909	778	1,142	1,004	422	289
	5			318	146	579	413	837	674	1,067	895	527	362
	6*					508	308	767	570	992	787	632	433
D79PAS	2	454	348	779	660	1,145	1,030					309	194
	3	365	207	678	501	1,048	876	1,412	1,243			463	291
	4	275	64	578	341	950	721	1,316	1,090	1,649	1,412	617	388
	5			478	181	854	566	1,221	938	1,549	1,253	772	485
	6*					756	411	1,125	785	1,448	1,092	926	582
D579PAS	2	816	647	1,376	1,186	1,997	1,813					536	352
	3	654	400	1,194	908	1,821	1,544	2,443	2,171			804	528
	4	492	154	1,012	631	1,644	1,275	2,270	1,907	2,878	2,497	1,072	704
	5			830	353	1,468	1,006	2,096	1,643	2,696	2,219	1,341	880
	6*					1,291	737	1,923	1,379	2,513	1,942	1,609	1,056

* Number of springs in standard unit