

# PDCPD "Giant" Butterfly Valve

## New Product from Asahi

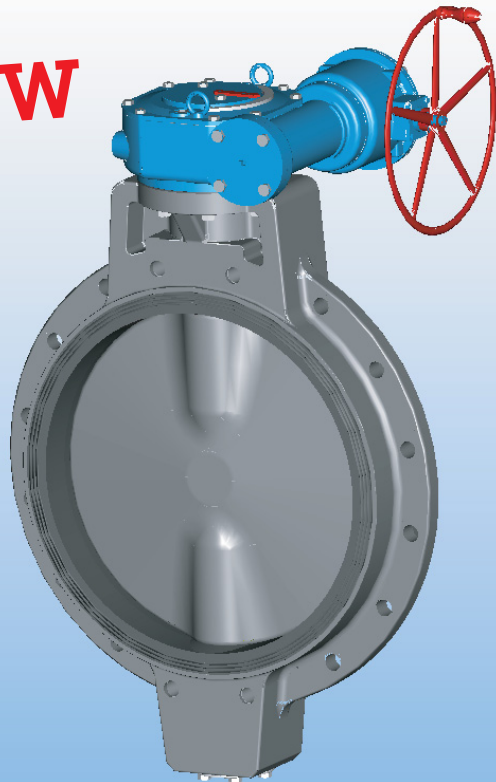

**NEW**



**Size Range: 28"-40"**  
**Max. Working Press.: 110 PSI**  
**Max. Working Temp.: 175 °F**  
**Model: Wafer Style**  
**Operator: Gear**  
**Body Material: PDCPD**  
**(Polydicyclopentadiene)**  
**Disc Material: PDCPD**  
**(Polydicyclopentadiene)**  
**Seat: EPDM, FKM**  
**Stem: Stainless Steel**

**New Product**

### Sample Specification

All PDCPD (Polydicyclopentadiene) butterfly valves sizes 28" thru 40" shall be of the lined body design and bubble-tight seal (meeting or exceeding Class VI as defined by American National Standard Institute) with only the liner and disc as wetted parts. Gear operators shall be worm gear design, self locking with cast iron body and corrosion resistant epoxy coat finish. The disc shall be of Spherical design for long cycle life. Liner shall be molded and formed around the body, functioning as gasket seals with convex ring design on each side of the valve for lower bolt tightening torque. Stem shall be of 304 stainless steel non wetted, 2-piece design fully engaging with the disc. Valves shall have a molded ISO bolt pattern top flange for accessory mounting. All valves shall be rated to a maximum of 110 psi at 70 degrees F. Butterfly valves shall be wafer style, as manufactured by Asahi/America inc.

**O-Ring Seals (EPDM, FKM)**  
For chemical resistance

**Non-Wetted Metal Parts**  
No-metal components ever come in contact with the media

**Disc: Spherical Design**  
For reduced break away and sealing torque

**Liner: Full Seat Design**  
Eliminates the need for additional gaskets

**Ductile Cast Iron Inserted Metal**  
into the Disc and Body for Strength

**ISO-5211 Top Flange**  
Industry standard for accessory mounting

**Body: Wafer Style**  
minimizes space requirement

**Stem: Dual Stems**  
2-piece stem fully engages with the disc

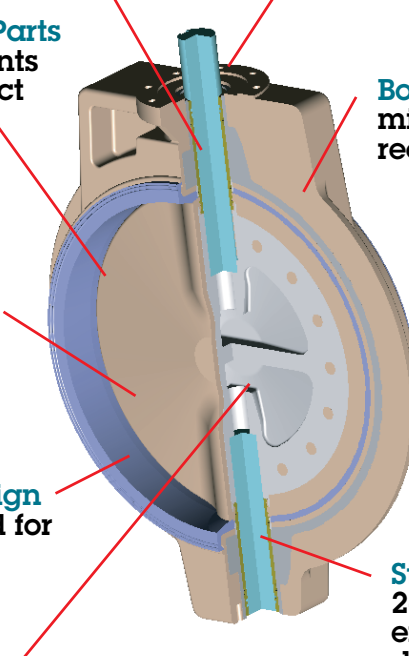

**NEW**  
Drawing

# PDCPD "Giant" Butterfly Valve

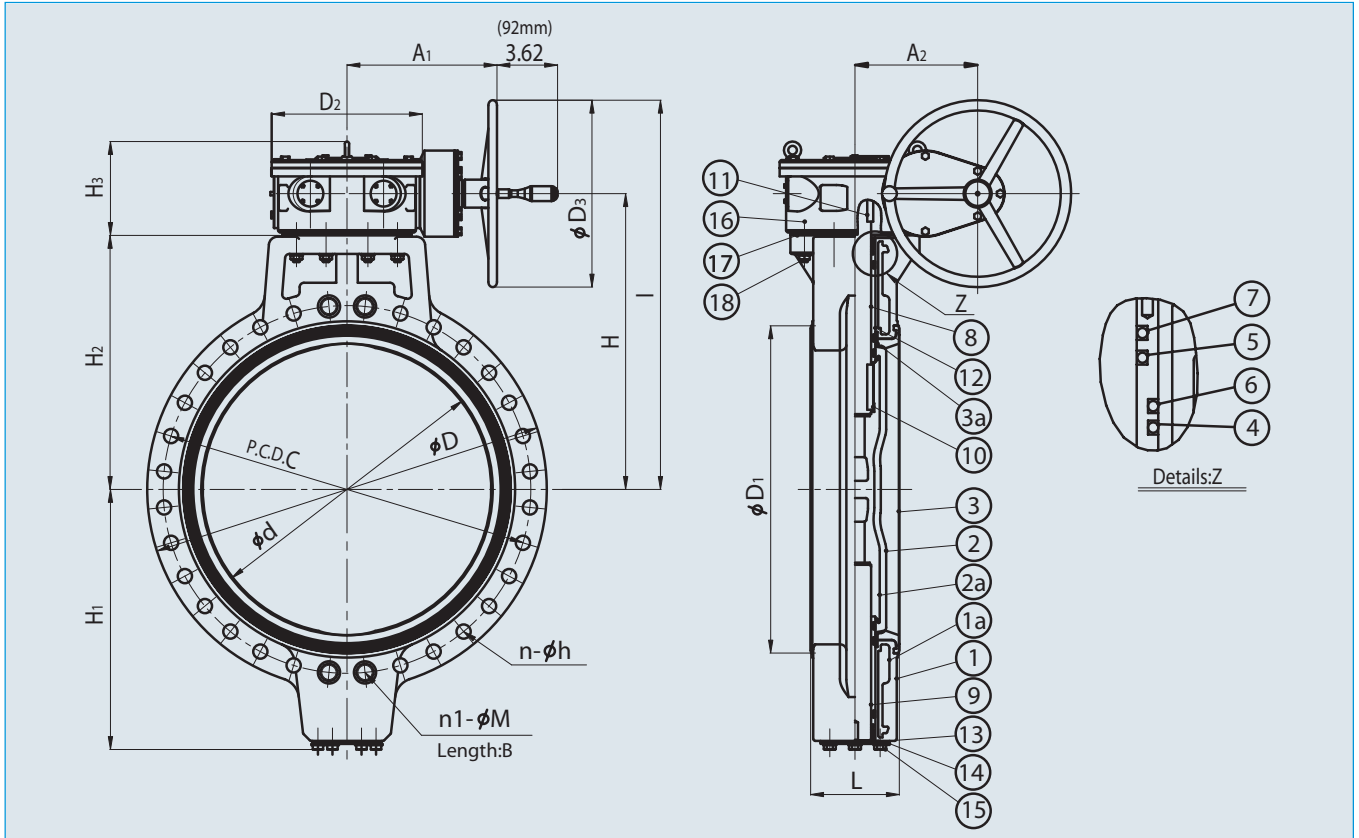

## Dimensions (Inches)

NOMINAL SIZE	ANSI CLASS 125/150																			Gear Box Model	
	INCHES	mm	d	C	n	h	h1	M	B	D	D1	D2	D3	L	A1	A2	H1	H2	H3		H
28	700	26.38	34.00	24	1.38	4	1-1/4	1.38	36.54	29.92	13.78	17.13	8.11	15.83	11.22	23.19	23.23	9.76	26.97	35.31	BRF10
32	800	30.31	38.50	24	1.62	4	1-1/2	1.38	41.34	34.25	13.78	17.13	9.45	15.83	11.22	24.37	24.41	9.76	28.15	36.50	BRF10
36	900	34.25	42.75	28	1.62	4	1-1/2	1.38	45.98	38.50	13.78	25.00	9.45	15.83	11.22	27.76	27.76	9.76	31.50	44.00	BRF10
40	1000	38.19	42.75	32	1.62	4	1-1/2	1.65	49.69	42.52	18.11	25.00	11.81	22.20	9.53	29.49	29.52	10.39	33.27	45.55	BRF20

## Dimensions (mm)

NOMINAL SIZE	DIN PN10																			Gear Box Model	
	INCHES	mm	d	C	n	h	h1	M	B	D	D1	D2	D3	L	A1	A2	H1	H2	H3		H
28	700	670	840	20	30	4	M27	35	928	760	350	435	206	402	285	589	590	248	685	897	BRF-10
32	800	770	950	24	33	4	M30	35	1034	870	350	435	240	402	285	619	620	248	715	927	BRF-10
36	900	870	1050	24	33	4	M30	35	1168	978	350	635	240	402	285	704	705	248	800	1112	BRF-10
40	1000	970	1160	24	36	4	M33	42	1262	1080	460	635	300	564	242	749	750	264	845	1157	BRF-20

## Parts List

PARTS			
NO.	DESCRIPTION	PCS.	MATERIAL
1	Body	1	PDCPD
2	Disc	1	PDCPD
3	Seat	1	FKM, EPDM
4	O-Ring (A)	11	FKM, EPDM
5	O-Ring (B)	3	FKM, EPDM
6	O-Ring (C)	1	NBR
7	O-Ring (D)	1	NBR
8	Stem (A)	1	Stainless Steel 304
9	Stem (B)	1	Stainless Steel 304
10	Key (A)	1	Carbon Steel
11	Key (B)	1	Carbon Steel
12	Bush	2	Bronze Casting (For EPDM Liner) PVDF (For FKM Liner)
13	Gasket (A)	1	Nonas Sheet
14	Stem Holder	1	Stainless Steel 304
15	Bolt (A)	6	Stainless Steel 304
16	Gear Box	1	Cast Iron (FC200 With Epoxy Coat)
17	Thrust Ring (A)	1	UHMEPE
18	Bolt (B)	8	Stainless Steel 304
19	Stabilization Ring	2	Stainless Steel 304
1a	Inserted Metal of Body	1	Cast Iron (FCD450)
1b	Inserted Metal of Disc	1	Cast Iron (FCD450)

## Cv Values

NOMINAL SIZE	Cv			
	INCHES	mm	30°	60°
28	700	3,600	13,000	32,000
32	800	4,200	17,000	43,000
36	900	5,600	22,000	55,000
40	1000	7,000	26,000	70,000

## Pres. vs. Temp. (NON-SHOCK)

NOMINAL SIZE	Pressure Vs Temp.		Weight (Lbs)	
	INCHES	mm		30-120° F
28	700	110 PSI	70 PSI	840
32	800	110 PSI	70 PSI	1015
36	900	110 PSI	70 PSI	1215
40	1000	110 PSI	70 PSI	1830

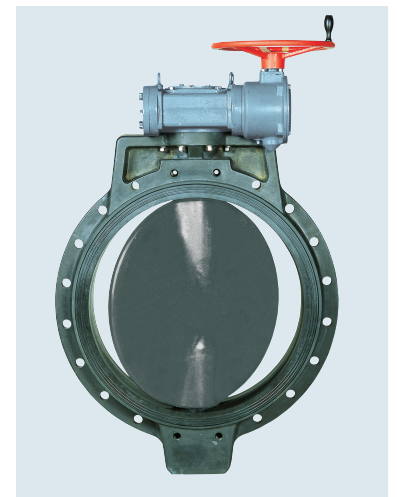

**ASAHI/AMERICA**

Rev. C 04-04